

## **FTX**

**Spare Parts Catalogue  
Catalogue de Pièces de Rechange  
Ersatzteilkatalog  
Onderdelencatalogus**

## Contents

Entry section No. 1+2	3
Entry section No. 3	4
Entry section No. 1-3	5
Entry section – hood	6
Module 600 mm	7
Module 900 mm	8
Tank heating + float switch	9
Tank heating – hot water and steam	10
Pump	11
Wash arms	12
Lateral wash arms	13
Drain	14
Rinse zone	15
Dual rinse	16
Booster el. heated	17
Booster 1,4 m <sup>2</sup> hot water + steam	18
Booster 0,6 m <sup>2</sup> hot water + steam	19
Condensers – Panels	20
Condensers C1, C2	21
Exhaust hood	22
Exhaust fan	23
Drier section D1	24
Drier section D2	25
Drier section D2-panels	26
Drier D1 + D2 pipework	27
D1 + D2 Blower el. + hot water + steam	28
Exit section	29
Exit section-conveyor drive	30
Exit section-conveyor drive	31
Conveyor + strainer system	32

## Inhalt

Zulaufstrecke Nr. 1+2	3
Zulaufstrecke Nr. 3	4
Zulaufstrecke Nr. 1-3	5
Haube Zulaufstrecke	6
Modul 600 mm	7
Modul 900 mm	8
Tankheizung + Schwimmerschalter	9
Tankheizung – Heißwasser + Dampf	10
Pumpe	11
Wascharme	12
Seitliche Wascharme	13
Ablauf	14
Klarspülzone	15
Duo-Nachspülung	16
Durchlauferhitzer el. beheizt	17
Durchlauferhitzer 1,4 m <sup>2</sup> HW + Dampfbeheizt	18
Durchlauferhitzer 0,6 m <sup>2</sup> HW + Dampfbeheizt	19
Kondensatoren-Verkleidung	20
Kondensatoren C1, C2	21
Wrasenabzug-Haube	22
Wrasenabzug-Ventilator	23
Trockenzone D1	24
Trockenzone D2	25
Trocknung D2 - Verkleidung	26
Trocknung D1 + D2 Ventilleitung	27
D1 + D2 Gebläse el. + HW + Dampfbeheizt	28
Auslaufzone	29
Auslaufzone-Bandantrieb	30
Auslaufzone-Bandantrieb	31
Band + Siebssystem	32

## Table des matières

Zone de chargement No. 1+2	3
Zone de chargement No. 3	4
Zone de chargement No. 1-3	5
Zone de chargement – capot	6
Module 600 mm	7
Module 900 mm	8
Chauffage de bac + interrupteur à flotteur	9
Chauffage de bac – eau chaud + vapeur	10
Pompe	11
Bras de lavage	12
Bras de lavage laterales	13
Vidange	14
Zone de rinçage	15
Double rinçage	16
Chaudière électrique	17
Chaudière 1,4 m <sup>2</sup> eau chaude + vapeur	18
Chaudière 0,6 m <sup>2</sup> eau chaude + vapeur	19
Condenseurs habillage	20
Condenseurs C1, C2	21
Extraction des buées - capot	22
Extraction des buées - ventilateur	23
Zone de séchage D1	24
Zone de séchage D2	25
Séchage D2 – panneaux	26
Séchage D1 + D2 tuyauterie	27
D1 + D2 Soufflage el. + eau chaude + vapeur	28
Zone de déchargement	29
Zone de déchargement-entraînement du convoyeur	30
Zone de déchargement-entraînement du convoyeur	31
Convoyeur + système des filtres	32

## Inhoud:

Toevoersectie No. 1+2	3
Toevoersectie No. 3	4
Toevoersectie No. 1-3	5
Toevoersectie Kap	6
Modul 600 mm	7
Modul 900 mm	8
Tankverwarming + Zwem-schakelaar	9
Tankverwarming – heet water + stoom	10
Pomp	11
Wasarmen	12
Zijdelingse wasarmen	13
Afvoer	14
Naspoelzone	15
Duo Naspoeling	16
Booster elektrisch	17
Booster 1,4 m <sup>2</sup> heet water + stoom verwarming	18
Booster 0,6 m <sup>2</sup> heet water + stoom verwarming	19
Kondensorbekleding	20
Kondensors C1, C2	21
Wasemafhuiging-kap	22
Wasemafhuiging-ventilator	23
Droogzone D1	24
Droogzone D2	25
Droogzone D2 - bekleding	26
Droging D1 + D2 Magneetklep	27
D1 + D2 Ventilator el. + heet water + stoom verwarming	28
Afvoersectie	29
Afvoersectie-transportbandaandrijving	30
Afvoersectie-transportbandaandrijving	31
Transportbanden + zeef systeem	32

L – R = Links – Rechts  
left – right  
gauche – droite  
links – rechts

R – L = Rechts – Links  
right – left  
droite – gauche  
rechts – links

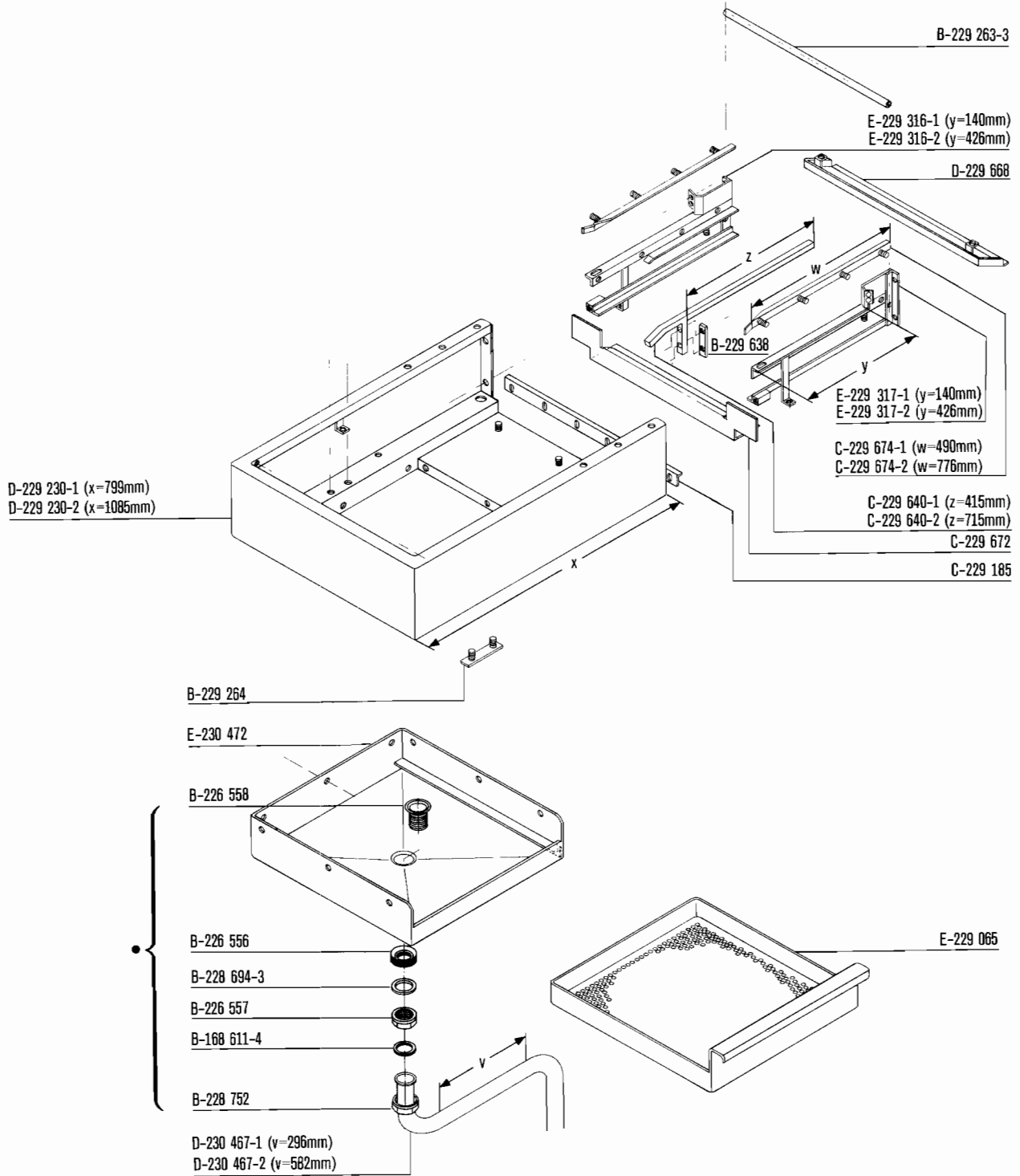
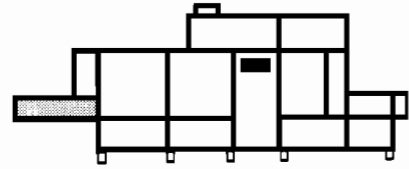

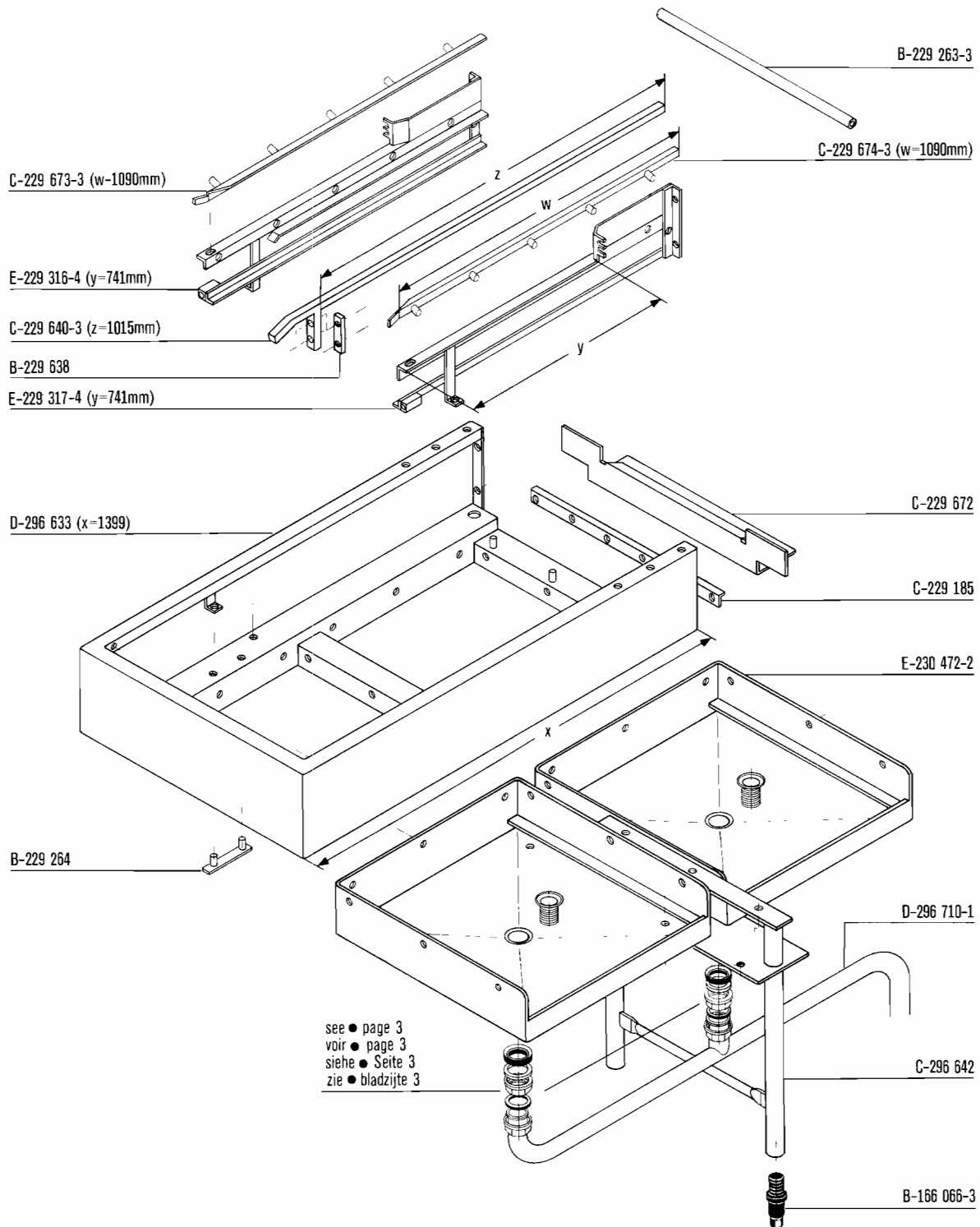
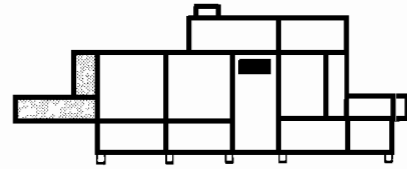

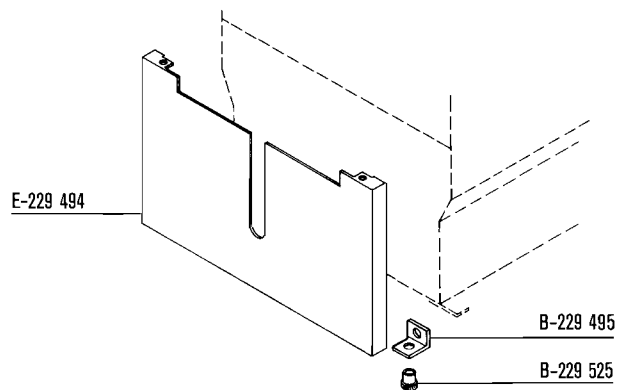
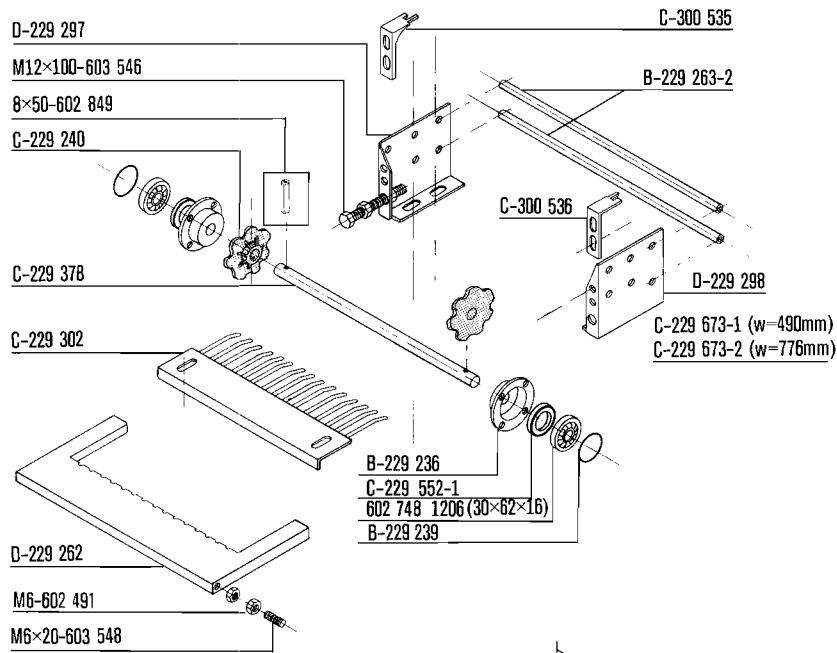
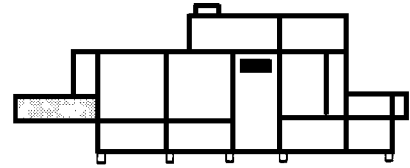

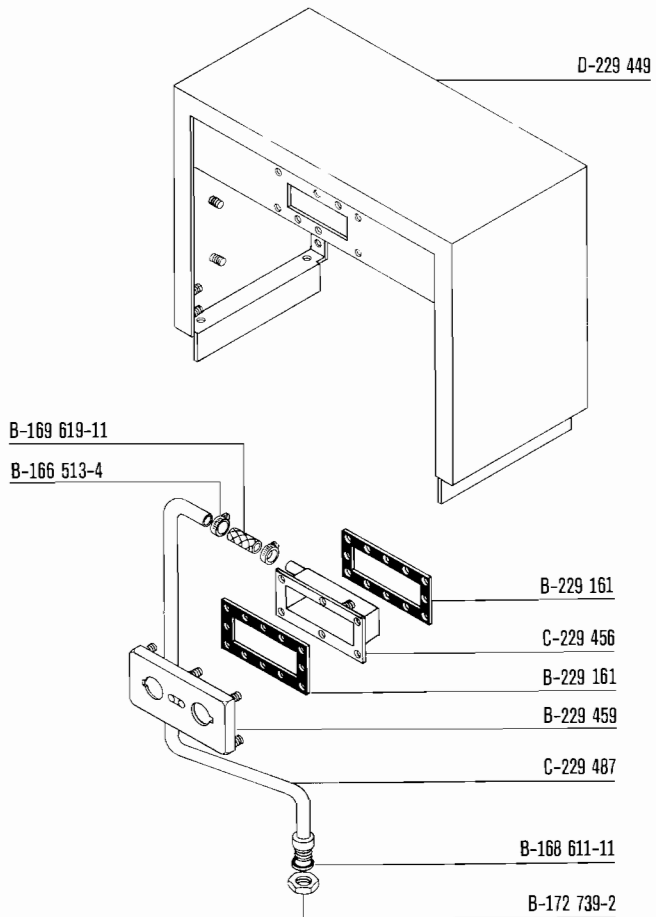
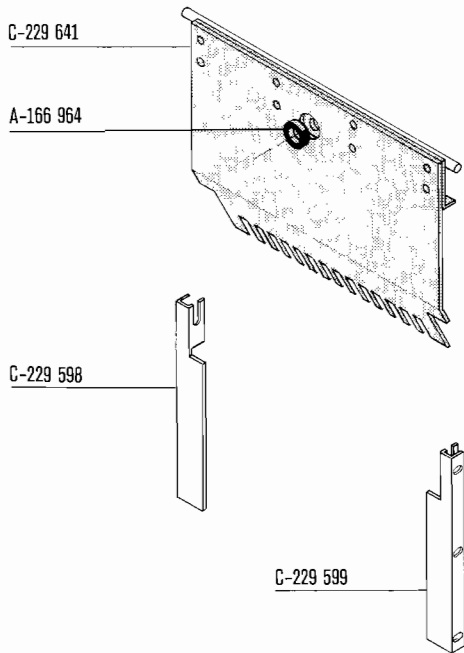
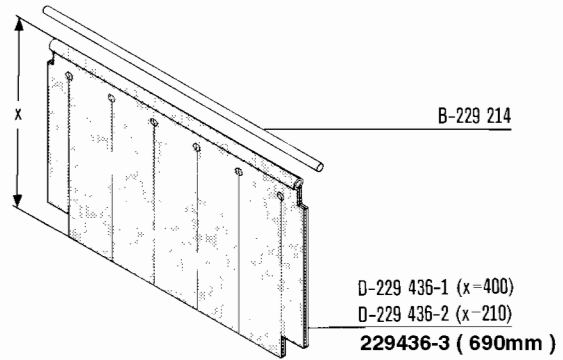
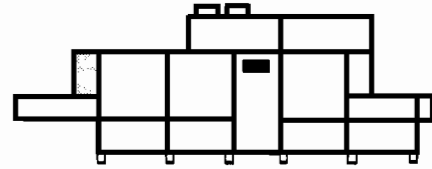

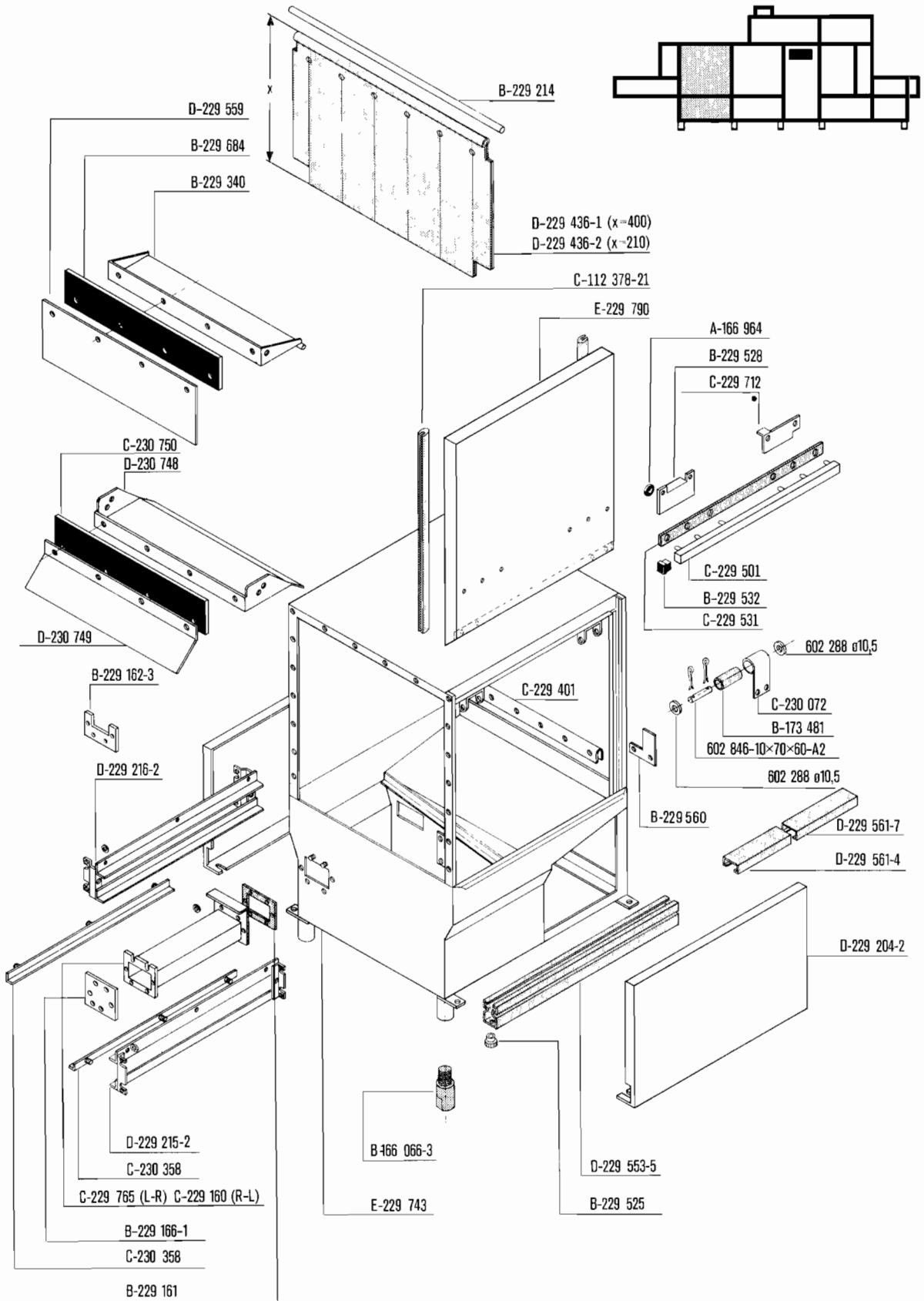

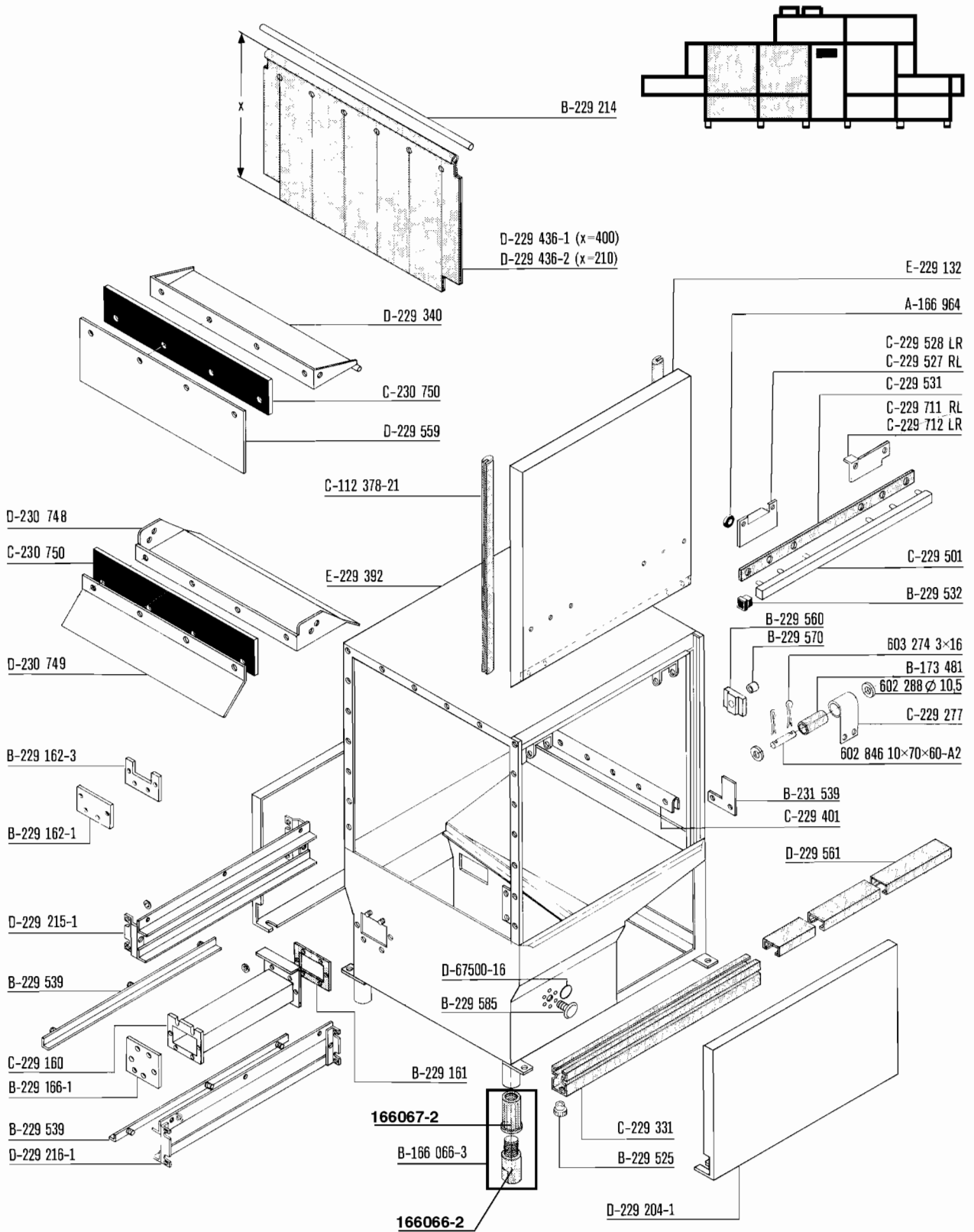



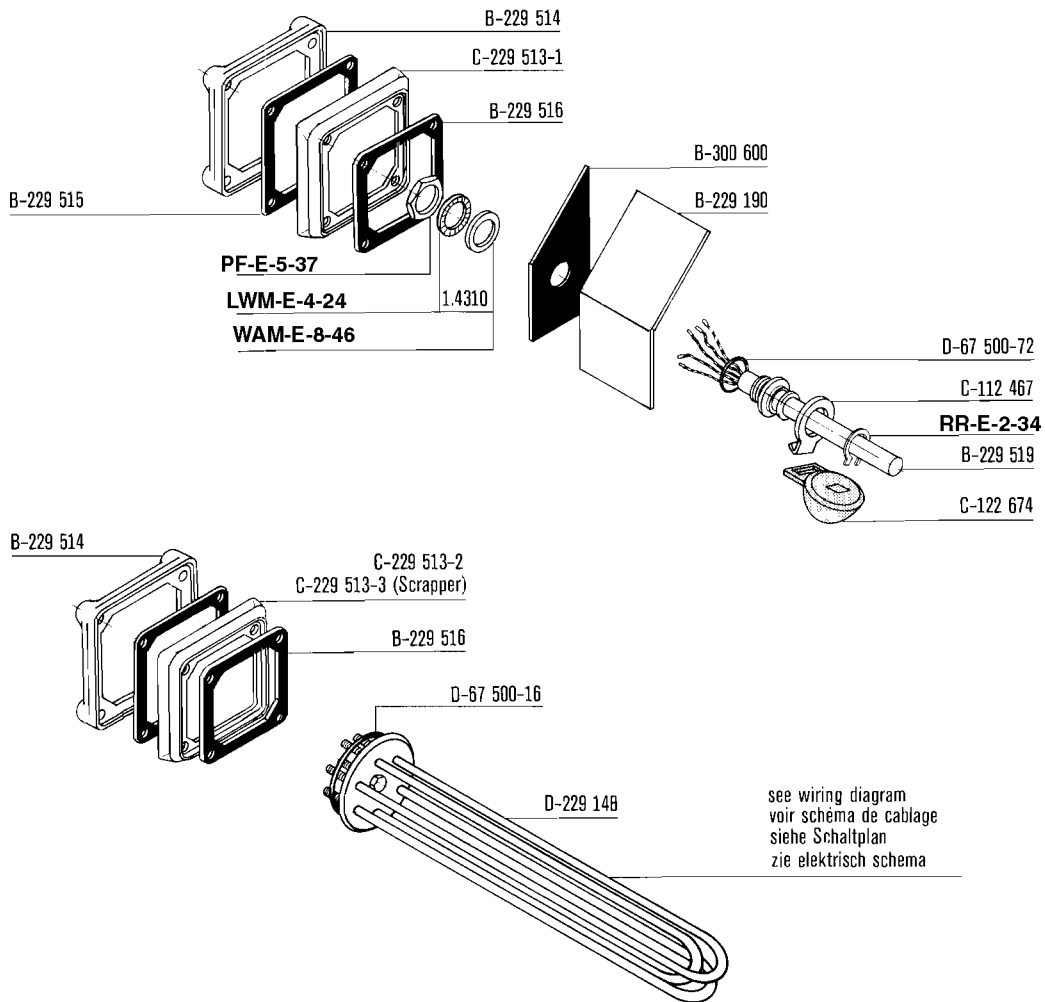
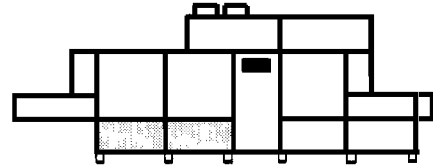

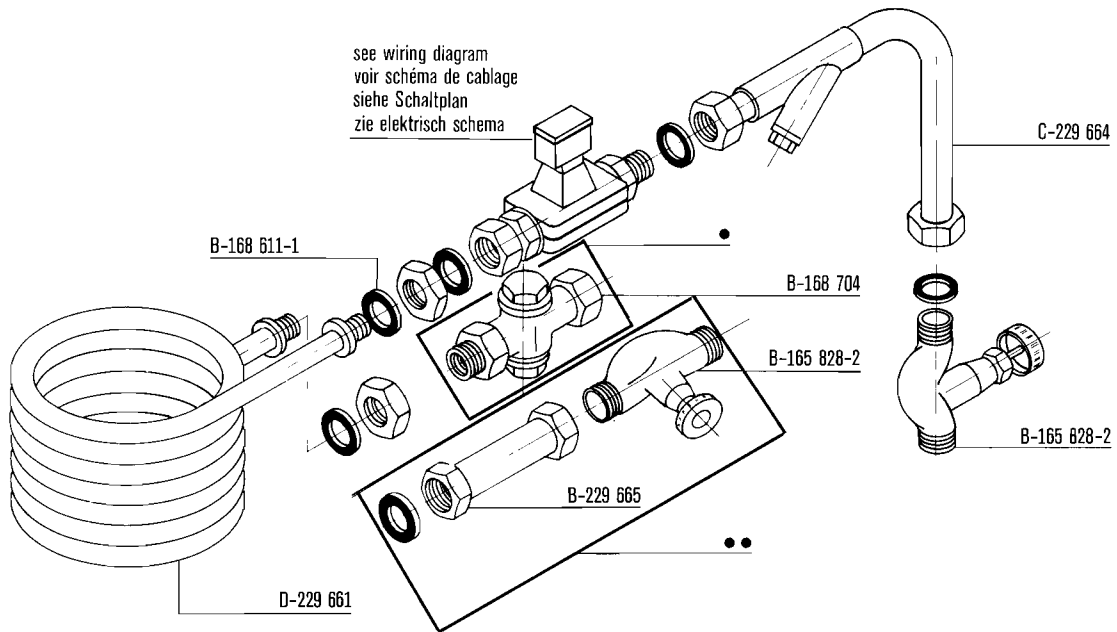
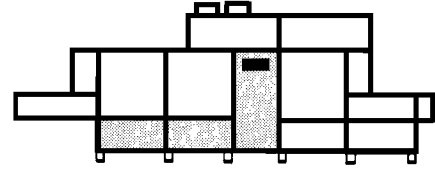

- steam
- vapeur
- Dampf
- stoom
- hot water
- eau chaude
- Heißwasser
- heet water

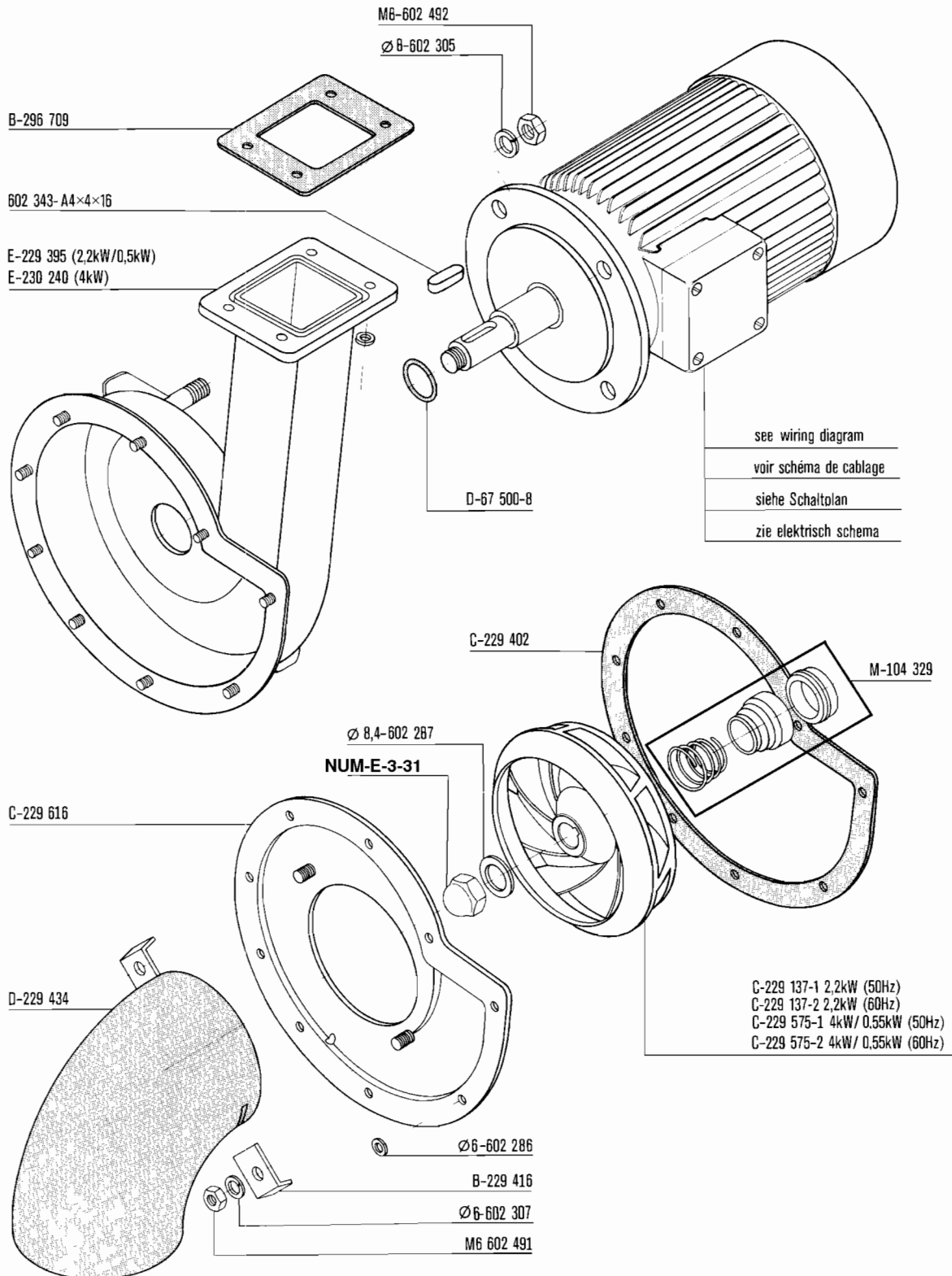
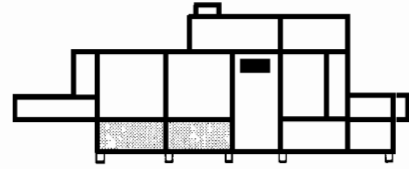

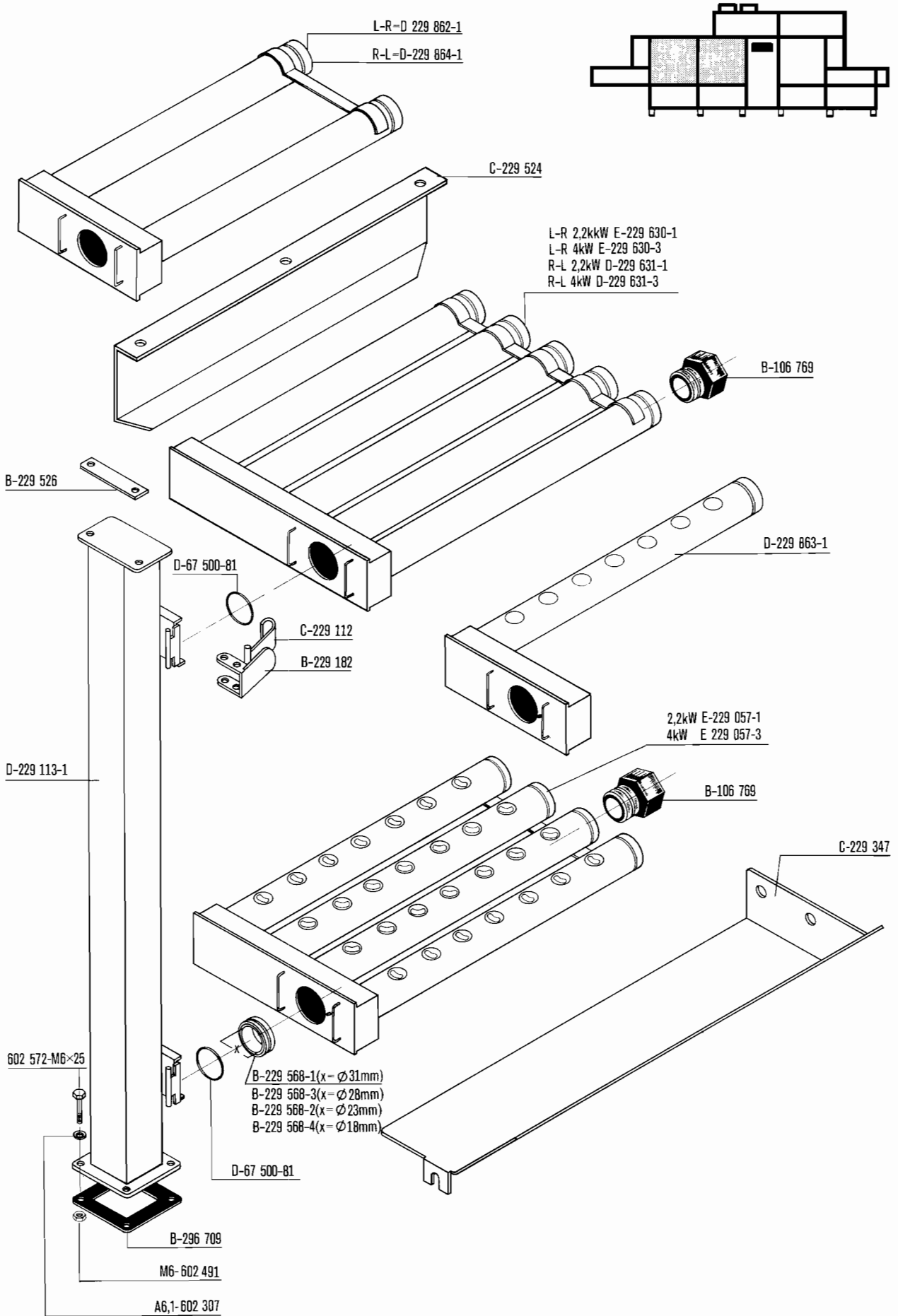

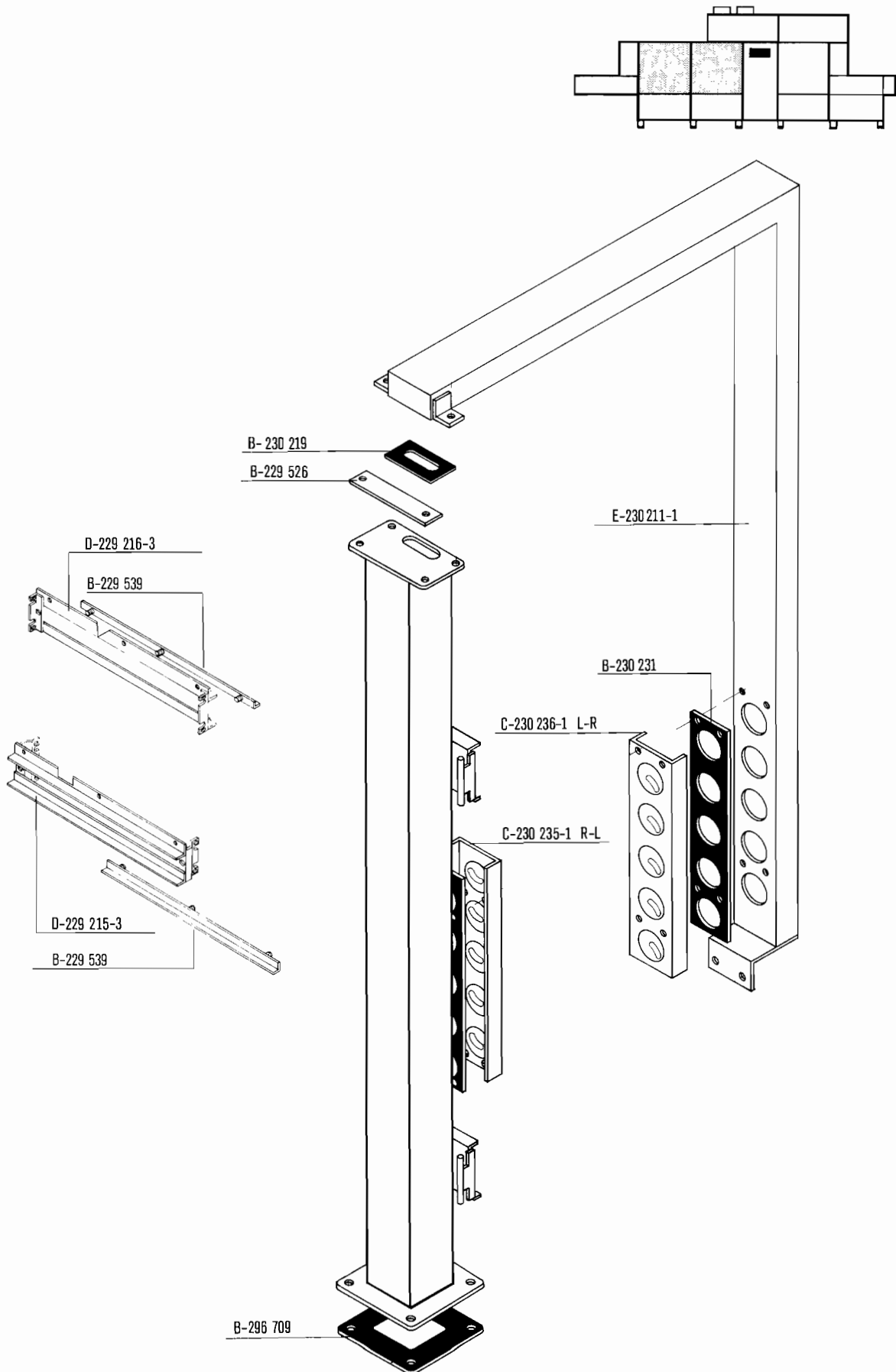

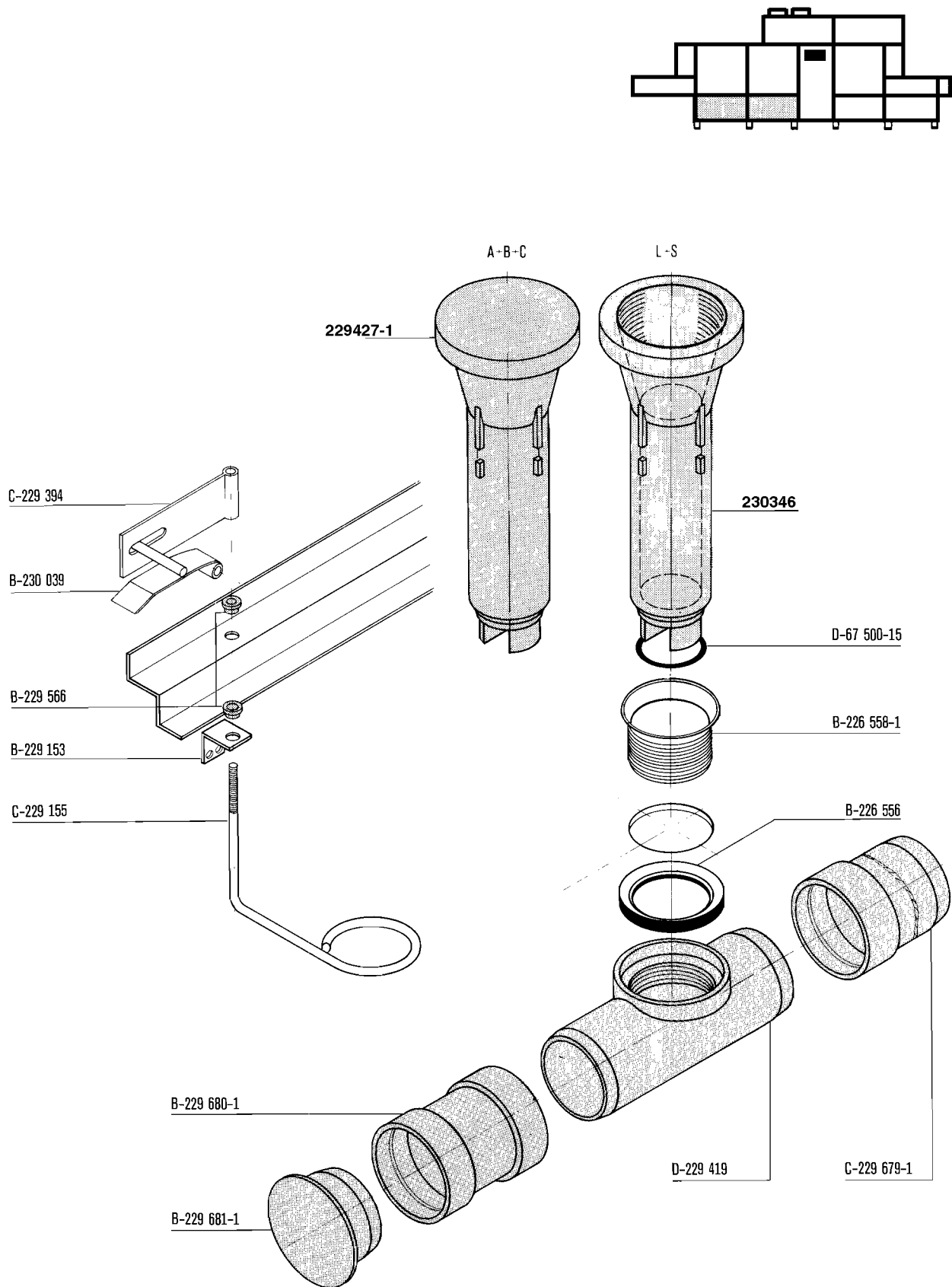

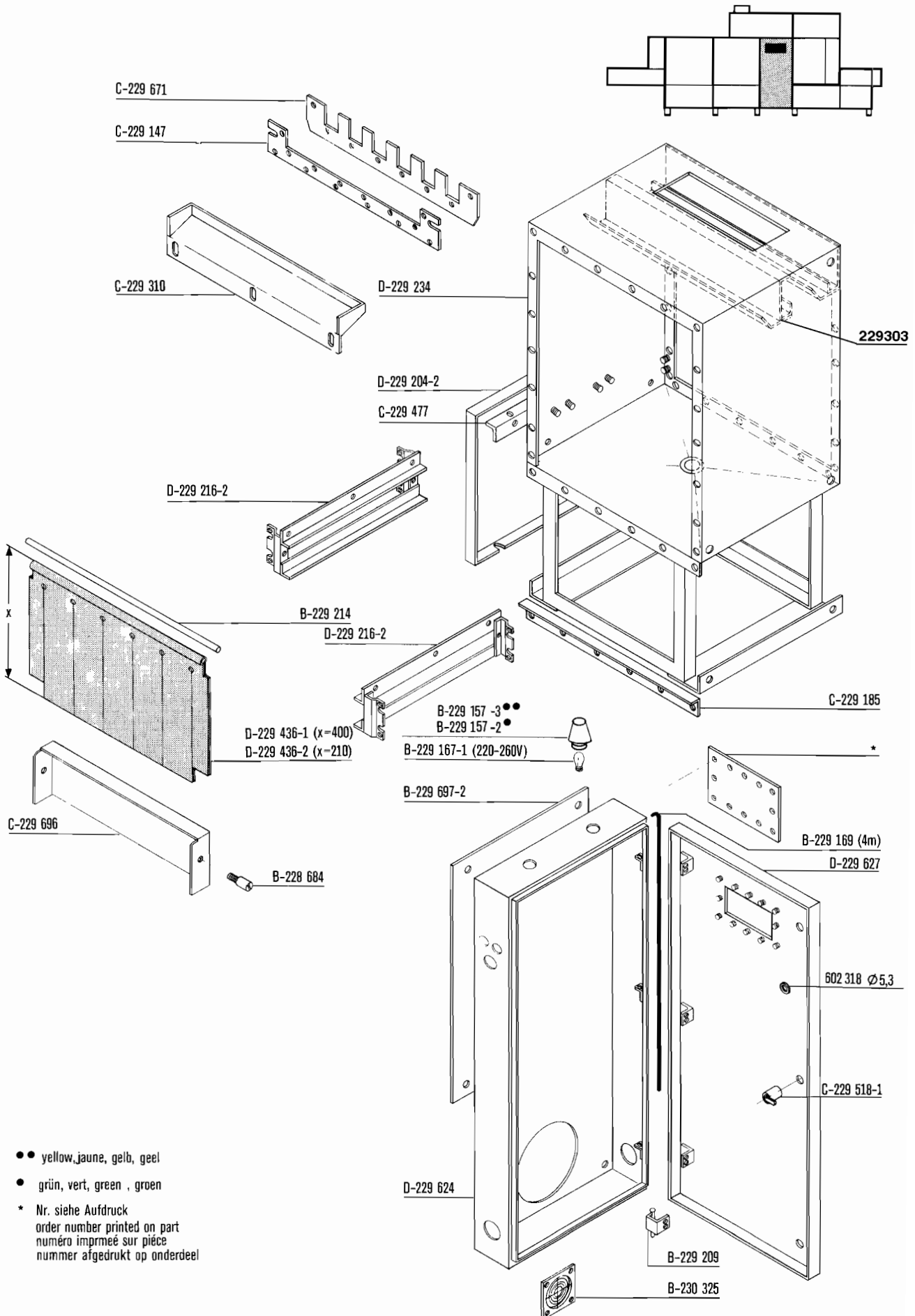

●● yellow, jaune, gelb, geel

● grün, vert, green, groen

\* Nr. siehe Aufdruck  
order number printed on part  
numéro imprimé sur pièce  
nummer afgedrukt op onderdeel

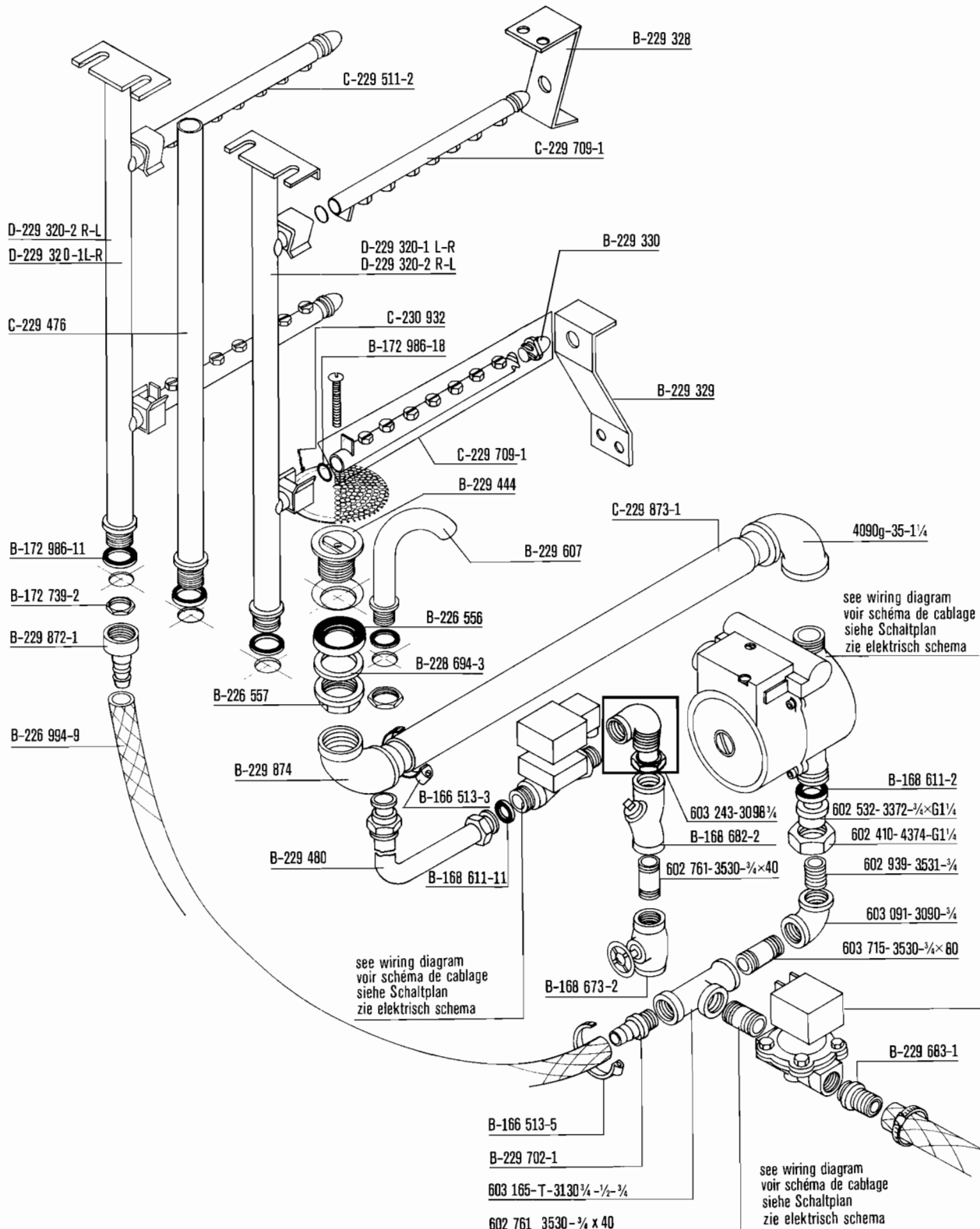
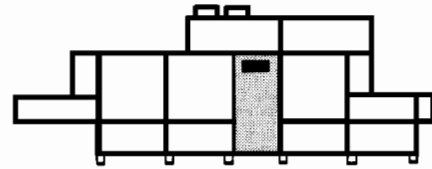



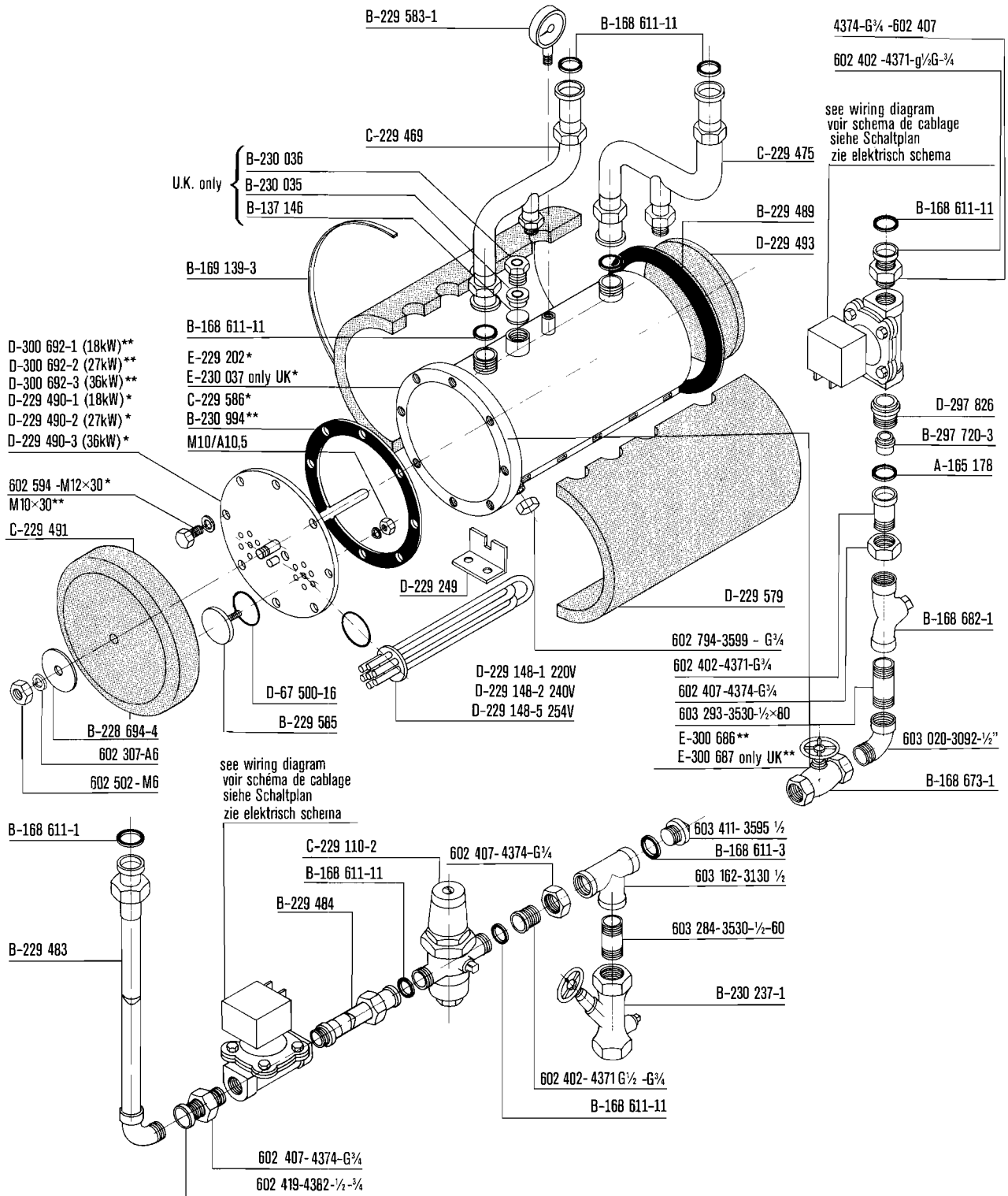
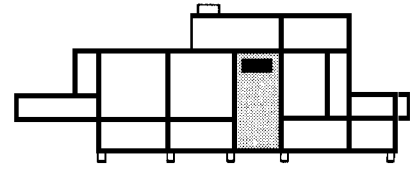

D-300 692-1 (18kW)\*\*  
D-300 692-2 (27kW)\*\*  
D-300 692-3 (36kW)\*\*  
D-229 490-1 (18kW)\*  
D-229 490-2 (27kW)\*  
D-229 490-3 (36kW)\*

E-229 202\*  
E-230 037 only UK\*C-229 586\*  
B-230 994\*\*  
M10/A10,5

602 594 -M12×30\*  
M10×30\*\*  
C-229 491

D-229 148-1 220V  
D-229 148-2 240V  
D-229 148-5 254V

602 794-3599 - G $\frac{3}{4}$   
602 402-4371-G $\frac{3}{4}$   
602 407-4374-G $\frac{3}{4}$   
603 293-3530- $\frac{1}{2}$ ×80  
E-300 686\*\*  
E-300 687 only UK\*\*

B-168 611-1

B-229 483

C-229 110-2

B-229 484

603 411- 3595  $\frac{1}{2}$

B-168 611-3

603 162-3130  $\frac{1}{2}$

603 284-3530- $\frac{1}{2}$ -60

B-230 237-1

602 402- 4371 G $\frac{3}{4}$  -G $\frac{3}{4}$

B-168 611-11

602 407- 4374-G $\frac{3}{4}$

602 419-4362- $\frac{1}{2}$ - $\frac{3}{4}$

\*8 hole,  
8 trous.  
8 Loch,  
8 gaten

\*\*10 hole,  
10 trous.  
10 Loch,  
10 gaten

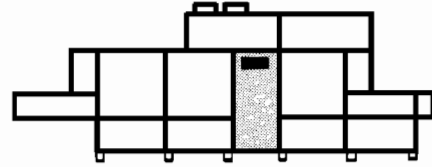

see wiring diagram  
 voir schéma de cablage  
 siehe Schaltplan  
 zie elektrisch schema

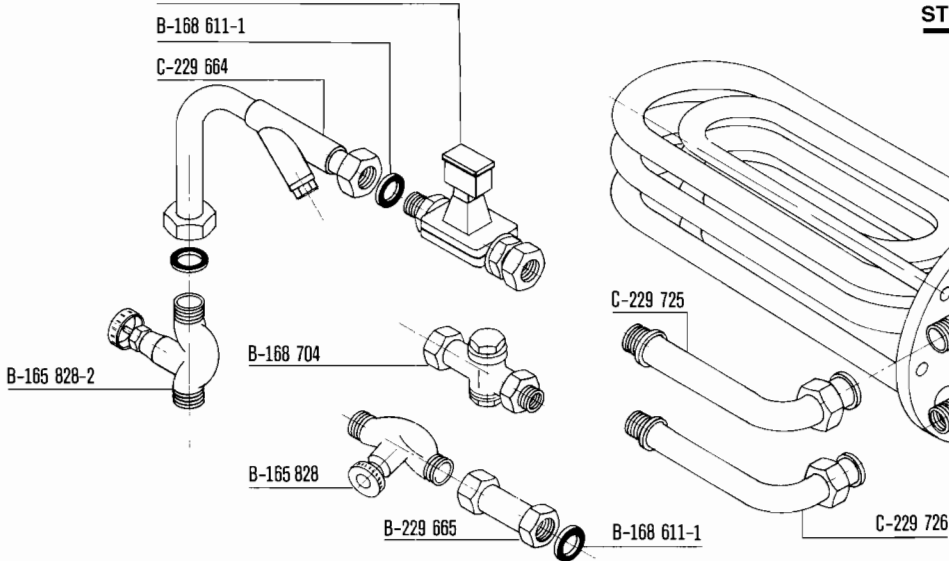

### STEAM BOOSTER ASSY, 300702

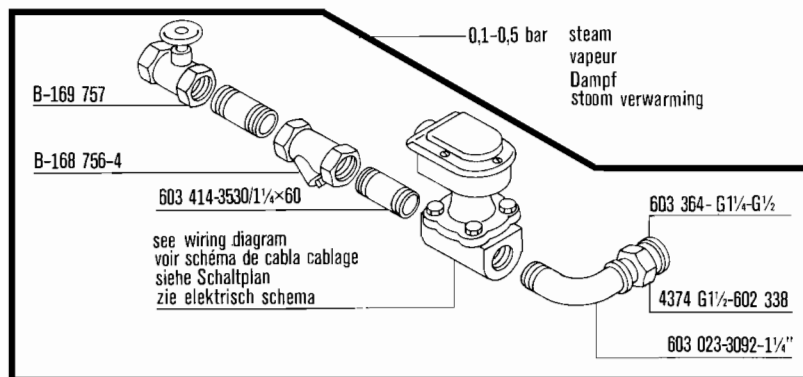

\* 8 hole, \*\* 10 hole,  
 8 trous, 10 trous,  
 8 Loch, 10 Loch,  
 8 gaten, 10 gaten

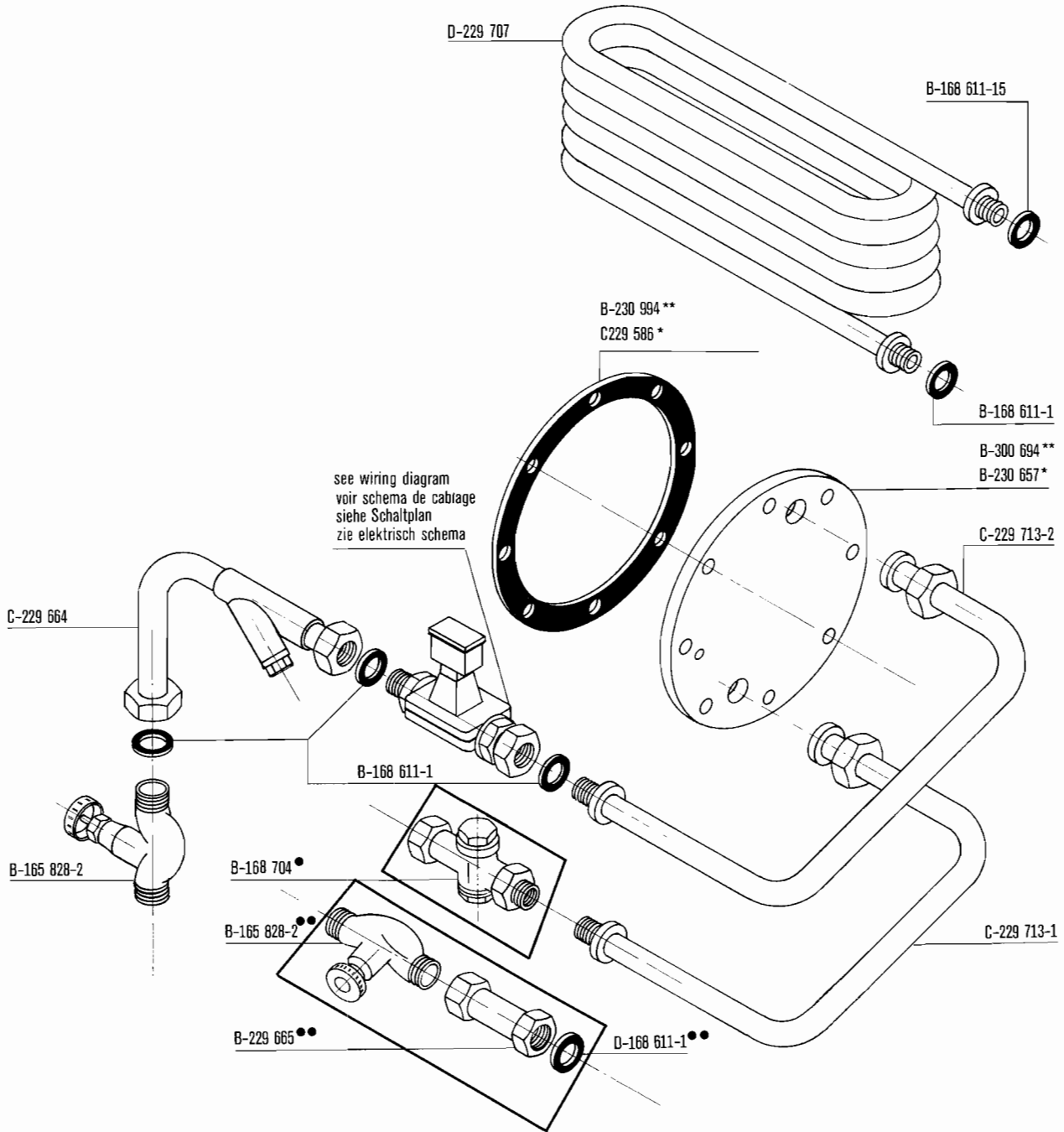
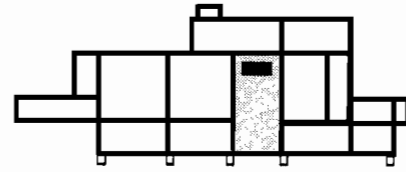

\* 8 hole    \*\* 10 hole  
 8 trous    10 trous  
 8 Loch    10 Loch  
 8 gaten    10 gaten

• steam    •• hot water  
 vapeur    eau chaude  
 Dampf    Heißwasser  
 stoom    heet water

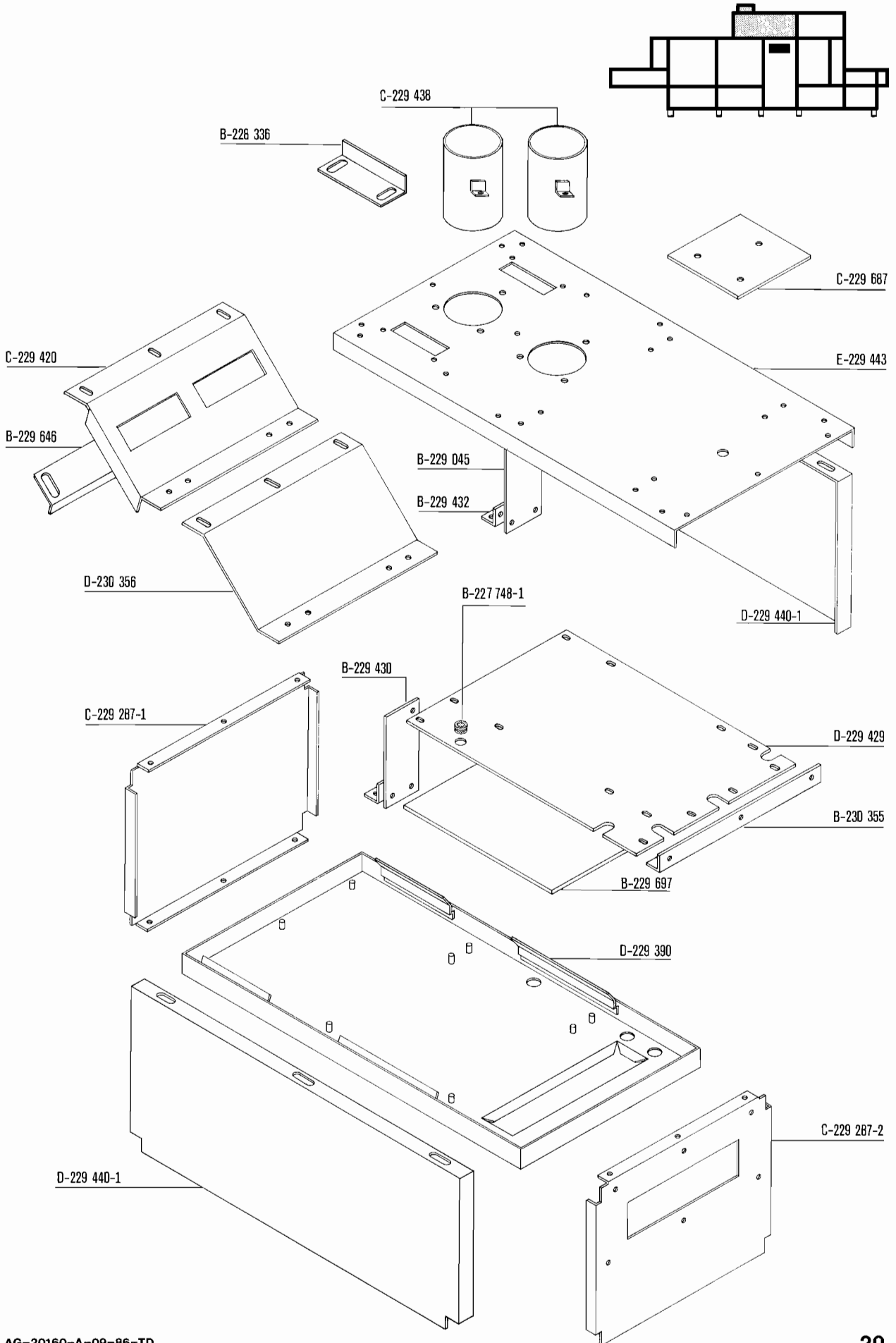

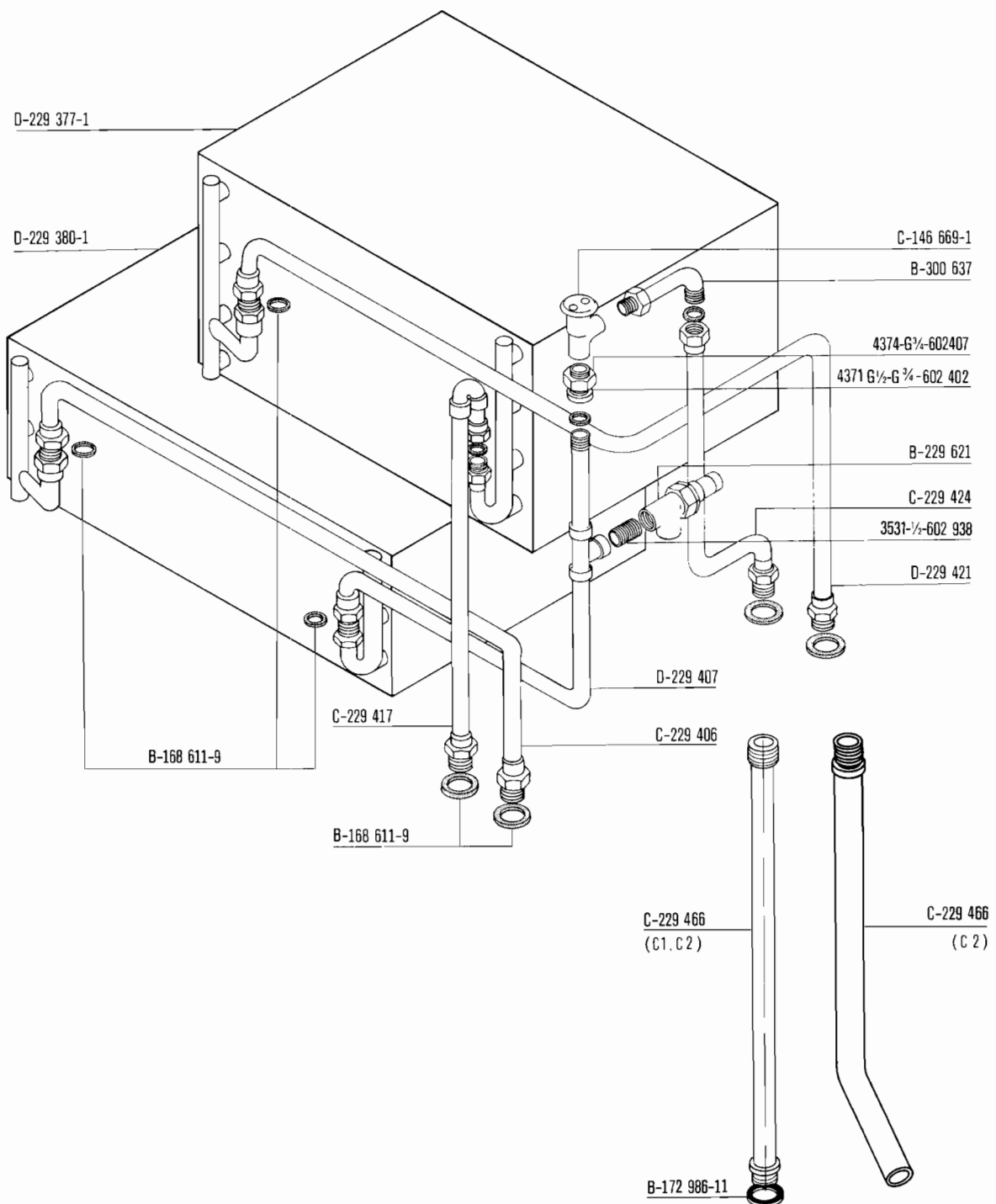
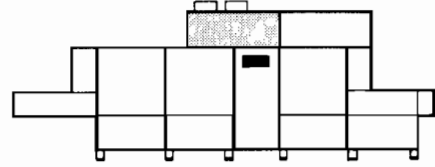

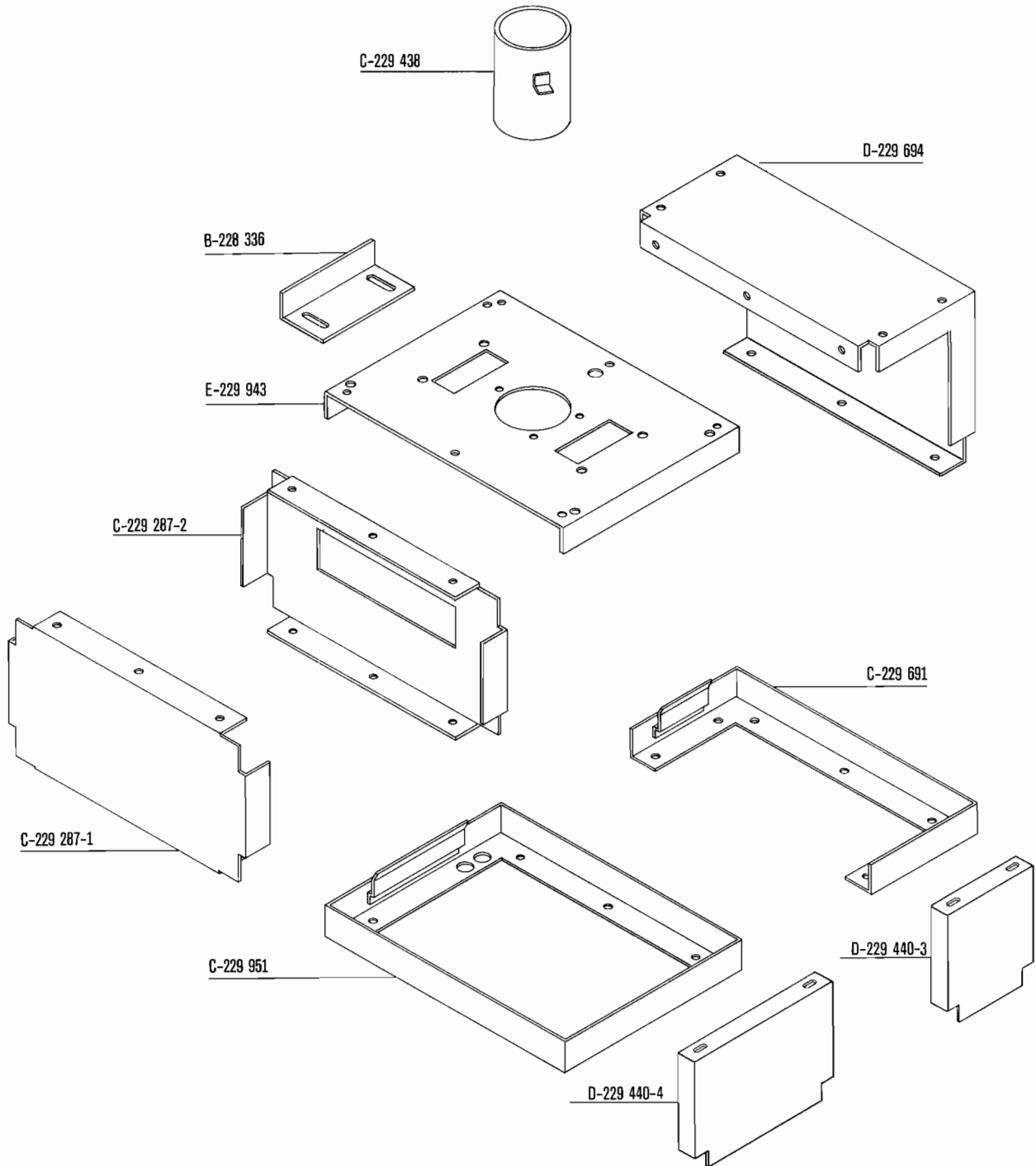
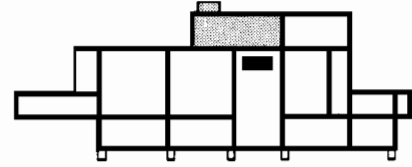

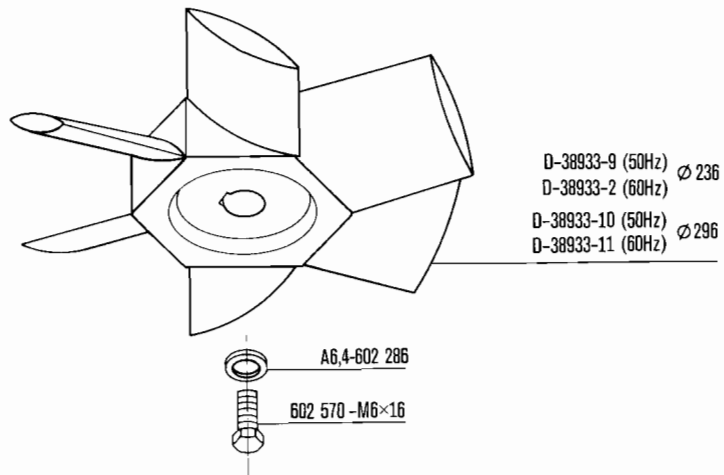
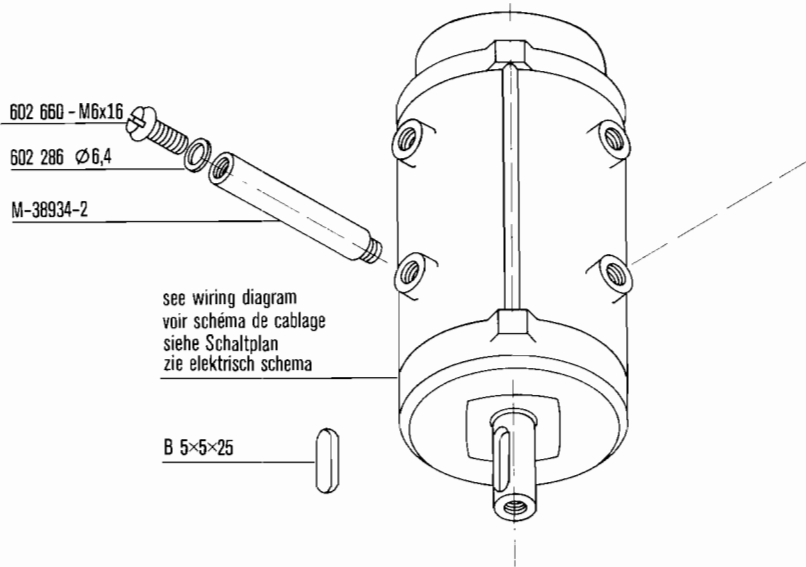
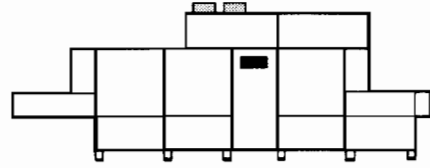

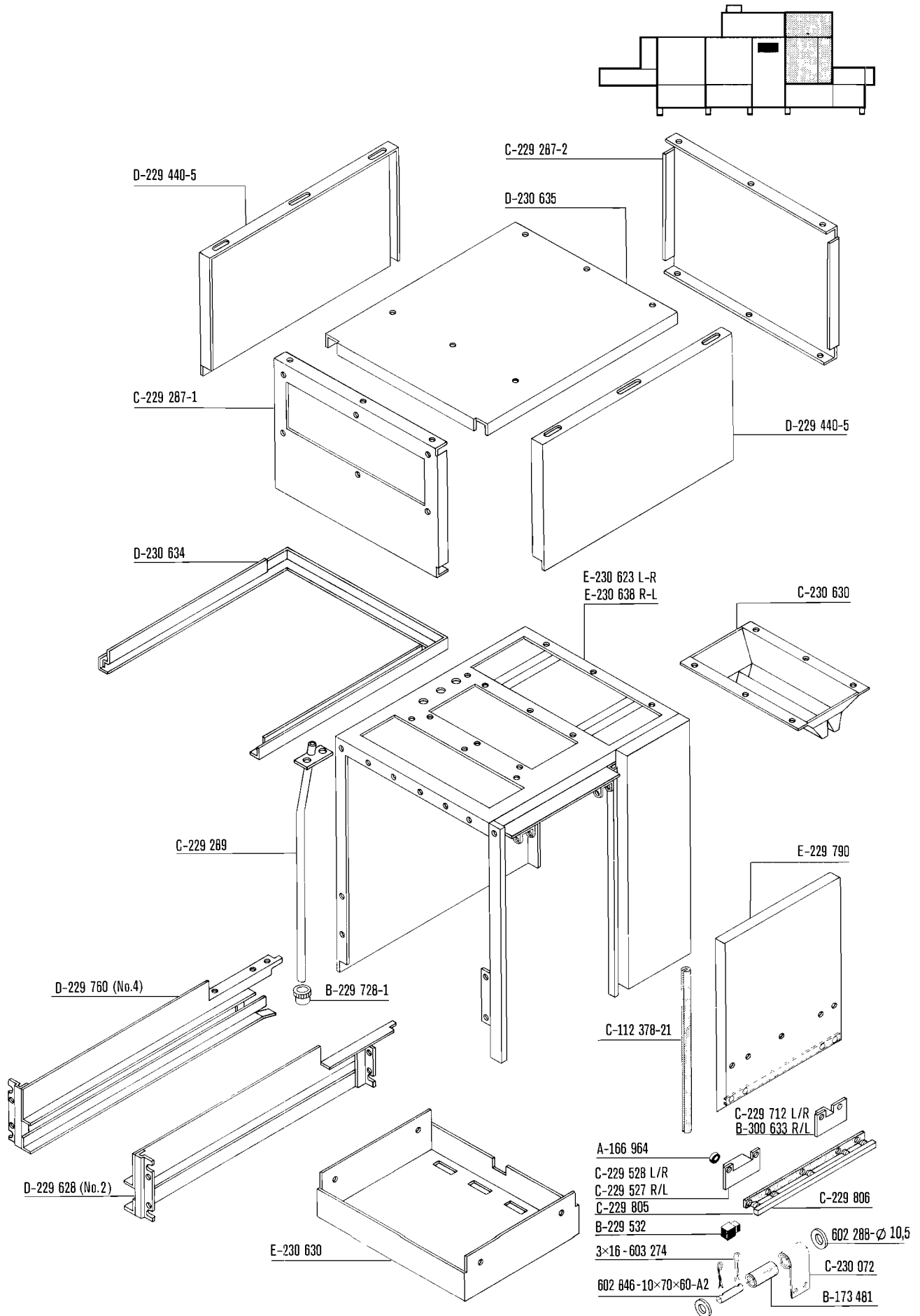



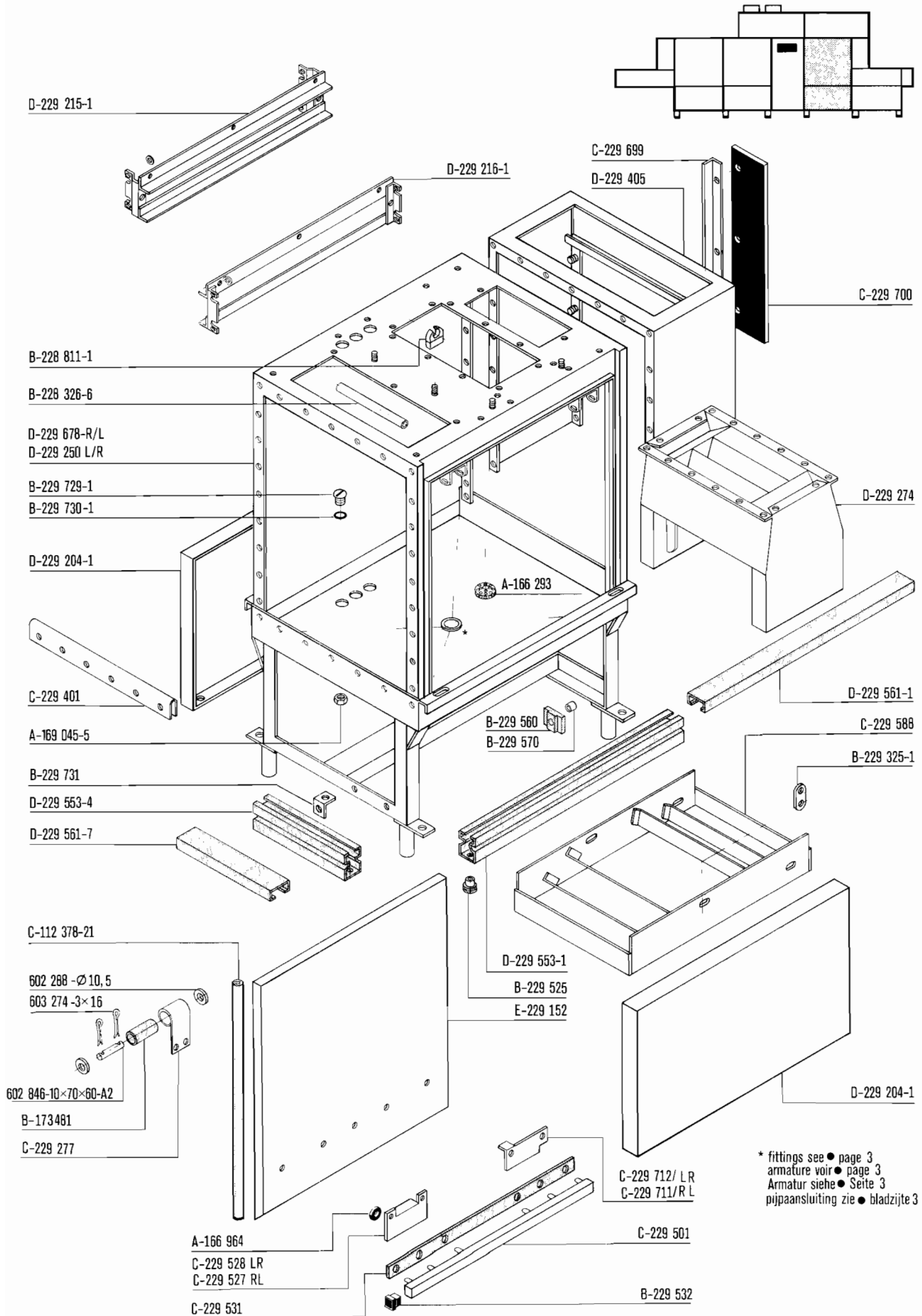

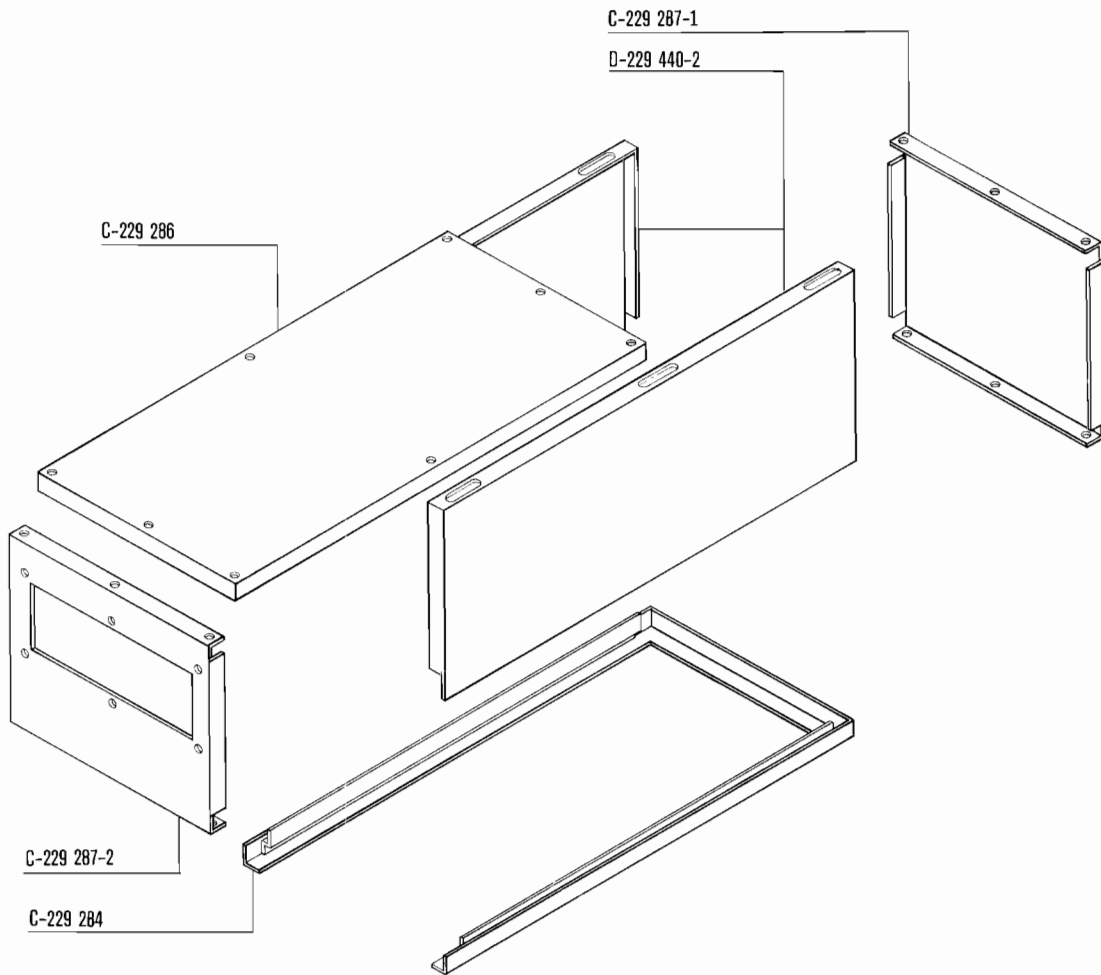
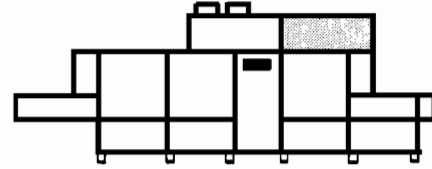

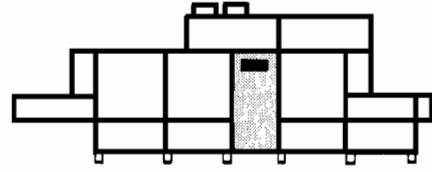

see wiring diagram  
 voir schéma de cablage  
 siehe Schaltplan  
 zie elektrisch schema

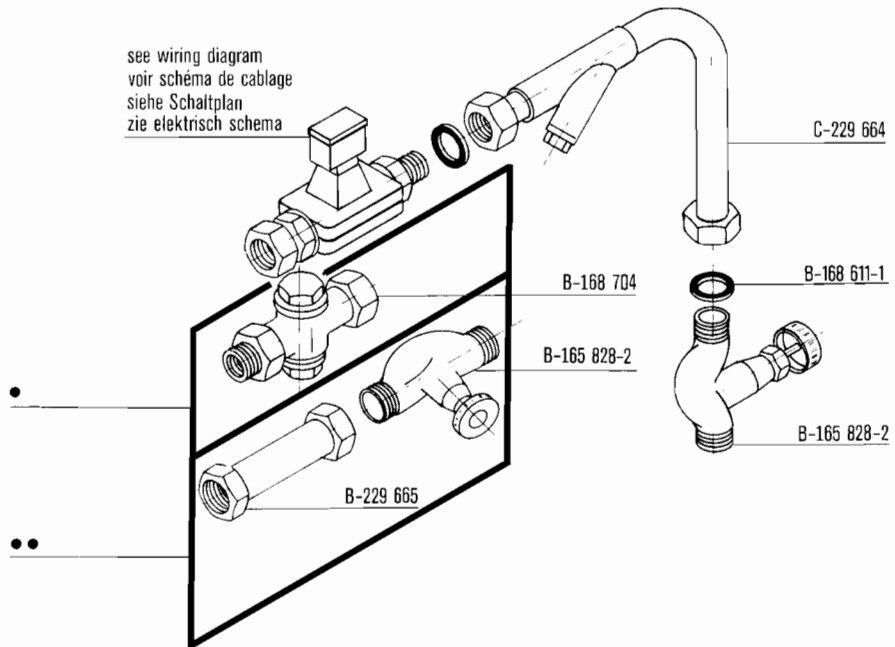

• steam  
 vapeur  
 Dampf  
 stoom

•• hot water  
 eau chaude  
 Heißwasser  
 heet water

\* see wiring diagram  
 voir schéma de câblage  
 siehe Schaltplan  
 zie electrisch schema

